

# TENON MOUNTED ARM

## XAJ

PROJECT NAME: \_\_\_\_\_

PROJECT TYPE: \_\_\_\_\_

### FEATURES

#### Arm

Durable corrosion resistant, cast aluminum construction.

#### Finish

Electrostatically applied TGIC Polyester Powder Coat on substrate prepared with 20 PSI power wash at 140°F. Four step media blast and iron phosphate pretreatment for protection and paint adhesion. 400°F bake for maximum hardness and durability.



**XAJ**

Patent pending

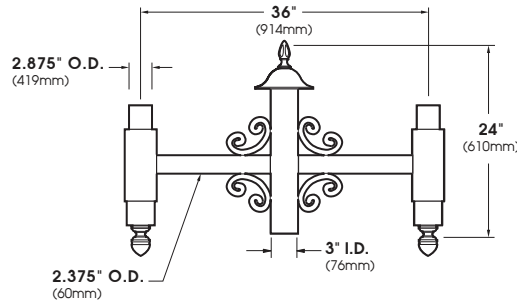

**XAJ-2-180**  
EPA = 1.60

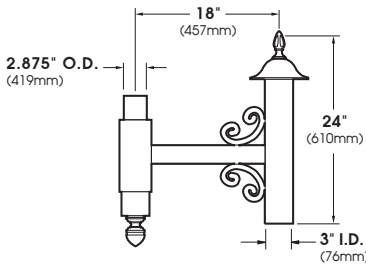

**XAJ-1**  
EPA = 0.99

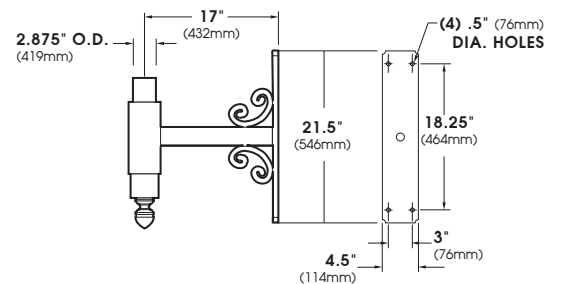









**XAJ-WM**  
EPA = 0.74

SCALE: 1/2"=1'

### ORDERING INFORMATION

Spec/Order Example: XAJ-1/RAL-9005-S

Configuration	<input type="checkbox"/>  XAJ-WM	<input type="checkbox"/>  XAJ-1	<input type="checkbox"/>  XAJ-2-180	<input type="checkbox"/>  XAJ-3-180	<input type="checkbox"/>  XAJ-3-120	<input type="checkbox"/>  XAJ-4-120	<input type="checkbox"/>  XAJ-4-90	<input type="checkbox"/>  XAJ-5-90
Finish*	<input type="checkbox"/> Black RAL-9005-T	<input type="checkbox"/> White RAL-9003-T	<input type="checkbox"/> Grey RAL-7004-T	<input type="checkbox"/> Dark Bronze RAL-8019-T	<input type="checkbox"/> Green RAL-6005-T	*Standard texture finish For smooth finish replace suffix "T" with suffix "S" (Example: RAL-9005-S) Consult factory for custom colors		