

7030

ACCENT FIXTURE

SPECIFICATIONS

FIXTURE: DIECAST ALUMINUM CONSTRUCTION. FIXTURE SUPPLIED WITH 1/2" NPT DIE CAST ALUMINUM ADJUSTABLE KNUCKLE.

LENS: CLEAR CONVEX, 1/4" TEMPERED GLASS.

GASKETING: LENS GASKET-"A" SCALE HIGH TEMPERATURE SILICONE.
SPLICE/BALLAST COMPARTMENT GASKET-60 S.D.H. "A" SCALE-DIE CUT NEOPRENE.

LAMP HOLDER: HID., INC. AND FLUORESCENT.-4KV PORCELAIN MEDIUM BASE.

LAMP: (BY OTHERS)

BALLAST: HIGH POWER FACTOR AUTOTRANSFORMER -20°F STARTING TEMPERATURE.

FASTENERS: 18-8 STAINLESS STEEL.

WIRING COMPONENTS: 14 GAUGE 200°C TEMPERATURE RATING. 1/4"-20 GROUNDING LUG PROVIDED.

SPLICE BOX: CONSTRUCTED OF PRIMARY 356 CAST ALUMINUM. ONE (1) 1/2" NPT MOUNTING ENTRY PROVIDED AT TOP, AND TWO (2) 3/4" NPT CONDUIT ENTRIES AT BOTTOM.
(INC MODEL)
(OPTIONAL)

BALLAST BOX: CONSTRUCTED OF PRIMARY 356 CAST ALUMINUM. ONE (1) 1/2" NPT MOUNTING ENTRY PROVIDED AT TOP OF THE SPLICE COMPARTMENT, TWO (2) 3/4" NPT CONDUIT ENTRIES PROVIDED AT BOTTOM. BALLAST COMPARTMENT ISOLATED FROM SPLICE COMPARTMENT BY AN ANTI-WICKING CHAMBER WHICH IS SEALED WITH AN EPOXY BASED RESIN.

FINISH: 3 MILS TGIC THERMOSET EPOXY POWDER COATING.

TESTING: FACTORY UNDER WATER POROSITY PRESSURE TEST TO 10 P.S.I. ON BALLAST BOX.

FACTORY CERTIFIED LEAK PREVENTION TEST ON 100% OF ALL FINISHED GOODS.

ETL LISTED FOR WET LOCATION AND CONCRETE POUR APPLICATIONS.

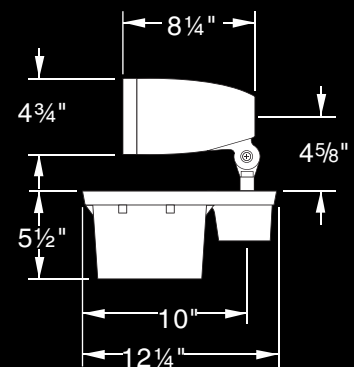

7030 (H.I.D.)

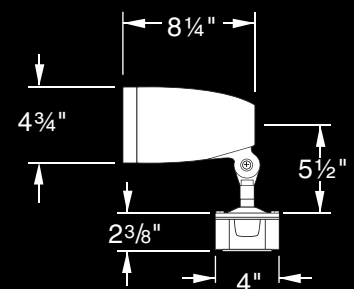

7030 (INC.)

7030

ACCENT FIXTURE

TYPE: _____

7030 (H.I.D.)

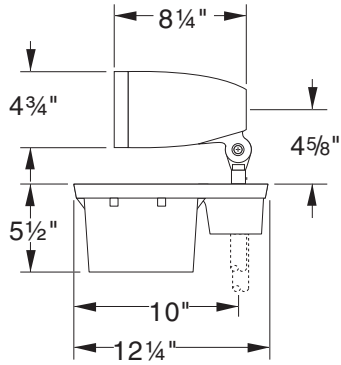

7030 (INC.)

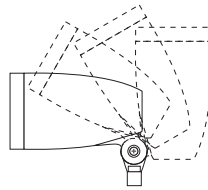
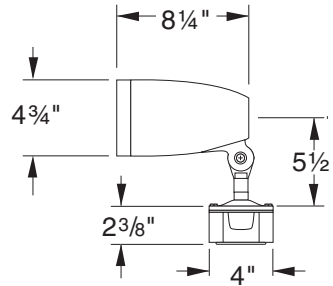

Field Adjustable to 90°

ORDERING INFORMATION

MODEL NO.: 7030

MODEL NO.:

7
0
3
0

PART NUMBERS

PART NUMBERS

- 7030-INC., PAR 30, 75W
- 7030-INC., R-30, 75W
- 7030-Q., PAR-16, 75W
- 7030-Q., PAR-30, 75W
- 7030-FL17, SLS17-R30, 17W
- 7030-MH 35, R-30, 35W
- 7030-MH 70, R-30, 70W

FINISH

FINISH

- DARK BRONZE. . . . DB
(STANDARD COLOR)
- BLACK.BK
- WHITE.WT
- ALUMINUM.AL

US ARCHITECTURAL. RESERVES THE RIGHT TO MAKE CONTINUED PRODUCT DESIGN AND CONSTRUCTION IMPROVEMENTS WHICH MAY AFFECT THE PRODUCT ILLUSTRATED

