

# SOLID STATE AREA LIGHTING

## AEROLUME SERIES - LED

### S P E C I F I C A T I O N S

#### HOUSING

Precise, one piece cast aluminum construction. Aerodynamic styling of housing features ribbed details. Housing is vented to provide free air flow around the LED module and Driver Compartment for thermal management and to minimize contaminants on the LED module.

#### LED OPTICAL MODULE

Low copper A356 alloy (<.2% copper) cast aluminum housing. Integrated clear tempered 3/16" glass lens sealed with a continuous silicone gasket protects emitters (LED's) and emitter Reflector-Prism optics, and seals the module from water intrusion and environmental contaminants. Module is sealed to meet an IP67 rating. LED's are available in standard Neutral White (4000K), or optional Cool White (5000K) or Warm White (3000K). Each emitter is optically controlled by a Reflector-Prism injection molded from H12 acrylic (3 types per module; one from 0° - 50°; one from 50° - 65°; one from 65° - 72°). Each Reflector-Prism has indexing pins for aiming and is secured to an optical plate made of matte black anodized aluminum. The optical plate locates every Reflector-Prism over an emitter. Reflector-Prisms are secured to the optical plate with a UV curing adhesive. The Reflector-Prisms are arrayed to produce IES Type II, III, IV, and V-SQ distributions. The entire Optical Module is field rotatable in 90° increments. Both module and drivers are factory wired using water resistant, insulated cord. Lens, module and drivers are field replaceable.

#### LED DRIVER

Drivers are UL and cUL recognized mounted on a single plate and factory prewired with quick-disconnect plugs. Constant current driver is electronic and has a power factor of >0.90 and a minimum operating temperature of -40°F. Drivers accept an input of 120-277V, 50/60Hz. (0 - 10V dimmable driver is standard. Driver has a minimum of 3KV internal surge protection.)

#### FINISH

Electrostatically applied TGIC Polyester Powder Coat on substrate prepared with 20 PSI power wash at 140°F. Four step iron phosphate pretreatment for protection and paint adhesion. 400°F bake for maximum hardness and durability. Texture finish is standard.

PROJECT NAME: \_\_\_\_\_

PROJECT TYPE: \_\_\_\_\_



**AER**

PATENT PENDING

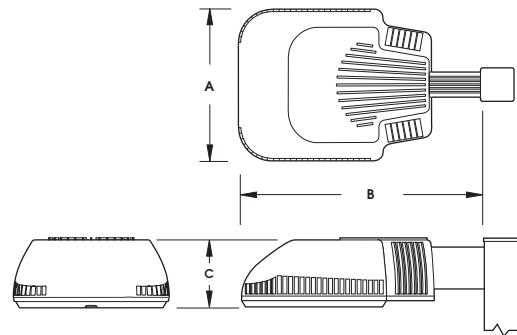

FIXTURE	A	B	C
<b>AER</b>	18" 457mm	29" 737mm	8" 203mm
<b>AERM</b>	13.5" 343mm	25" 635mm	6.5" 165mm



2015188

# AEROLUME SERIES - LED

## SPECIFICATIONS

### POLE DRILLING TEMPLATE

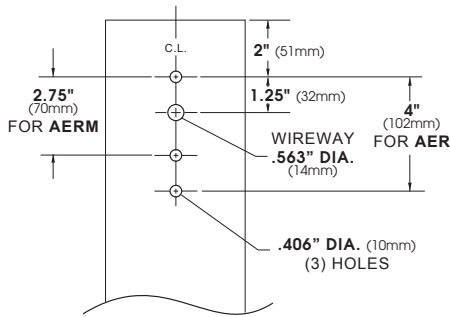

### OVERVIEW

PRECISE CAST ALUMINUM HOUSING AND DOOR FRAME. VENTED TO PROVIDE AIR FLOW AROUND LED MODULE FOR THERMAL MANAGEMENT.

SELF CONTAINED, LENSED LED MODULE.

PROPRIETARY LED OPTICS SEALED IN LED MODULE.

LED DRIVER ACCEPTS FROM 100-277 VAC INPUT VOLTAGE.

### WALL MOUNT

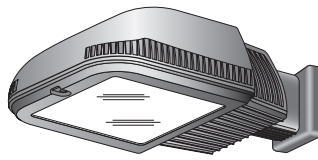

EXTRUDED ALUMINUM ARM AND CAST ALUMINUM WALL BRACKET ASSEMBLY PROVIDED WITH BUILT IN GASKETED WIRE ACCESS FOR FIXTURE/SUPPLY WIRE CONNECTION.

### WALL PLATE

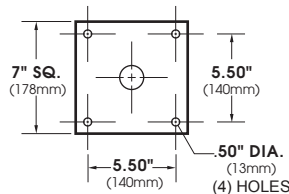

### VLED® MODULES



**AER** E.P.A. = 1.40  
Available in:  
120, 100, 80 & 64  
LED Module

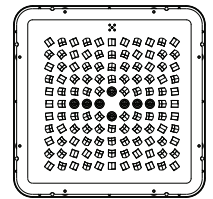

120 LED Module

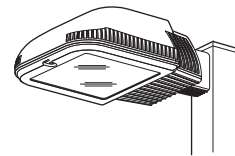

**AERM** E.P.A. = .91  
Available in:  
64 & 48  
LED Module

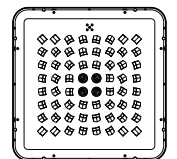

64 LED Module

### MAX INPUT WATTAGE

LED's	DRIVE CURRENT	
	350mA	525mA
120	130W	--
100	108W	--
80	85W	130W
64	70W	108W
48	55W	79W

## SPEC / ORDERING INFORMATION

LUMINAIRE	OPTICS	# of LED's	COLOR	VOLTAGE	MOUNTING	FINISH	OPTIONS
<b>LUMINAIRE</b>	<b>OPTICS</b>	<b>LED</b>			<b>MOUNTING</b>	<b>FINISH</b>	<b>OPTIONS</b>
<b>LUMINAIRE</b>	<b>VLED® IES DISTRIBUTION TYPE</b>	<b>No. LEDs</b>	<b>DRIVE CURRENT</b>	<b>COLOR</b>	<b>ARM MOUNT</b>	<b>STANDARD TEXTURED FINISH</b>	
<input type="checkbox"/> AER	<input type="checkbox"/> VLED - II ..... (Type-II)	<input type="checkbox"/> 120LED <sup>1</sup>	<input type="checkbox"/> 525mA	<input type="checkbox"/> NW (4000K) *STANDARD	<input type="checkbox"/> 1 ..... (TO FIT OVER 2 3/8" O.D. ARM)	<input type="checkbox"/> BLACK RAL-9005-T	<input type="checkbox"/> HOUSE SIDE SHIELDED REFLECTOR-PRISMS. . . . . <b>HS-VLED</b>
<input type="checkbox"/> AERM	<input type="checkbox"/> VLED - III ..... (Type-III)	<input type="checkbox"/> 100LED <sup>1</sup>	<input type="checkbox"/> 350mA	<input type="checkbox"/> CW (5000K)	<b>STREET LIGHTING ARM MOUNT</b>	<input type="checkbox"/> WHITE RAL-9003-T	<input type="checkbox"/> HIGH-LOW DIMMING FOR HARDWIRED SWITCHING OR NON-INTEGRATED MOTION SENSOR. . . . . <b>HLSW</b>
	<input type="checkbox"/> VLED - IV ..... (Type-IV)	<input type="checkbox"/> 80LED		<input type="checkbox"/> WW (3000K)	<input type="checkbox"/> ST23 ..... (TO FIT OVER 2 3/8" O.D. ARM)	<input type="checkbox"/> GREY RAL-7004-T	<input type="checkbox"/> PHOTO CELL + VOLTAGE (EXAMPLE: PC120V) . . . . . <b>PC+V</b>
	<input type="checkbox"/> VLED - VSQ ..... (Type-VSQ)	<input type="checkbox"/> 64LED		OTHER LED COLORS AVAILABLE CONSULT FACTORY	<b>ADJUSTABLE KNUCKLE</b>	<input type="checkbox"/> DARK BRONZE RAL-8019-T	<input type="checkbox"/> TWIST LOCK PHOTOCELL +VOLTAGE . . . . . <b>TPC+V</b>
		<b>AERM</b>		<b>VOLTAGE</b>	<input type="checkbox"/> NKLE23 ..... (TO FIT OVER 2 3/8" O.D.)	<input type="checkbox"/> GREEN RAL-6005-T	<input type="checkbox"/> TWIST LOCK PHOTOCELL RECEPTACLE ONLY. . . . . <b>TPR</b>
		<input type="checkbox"/> 64LED		<input type="checkbox"/> 120	<input type="checkbox"/> NKLE27 ..... (TO FIT OVER 2 7/8" O.D.)		<input type="checkbox"/> SINGLE FUSE (120V. . . 277V) . . . . . <b>SF</b>
		<input type="checkbox"/> 48LED		<input type="checkbox"/> 208	<b>WALL MOUNT</b>		<input type="checkbox"/> DOUBLE FUSE (208V. . . 240V) . . . . . <b>DF</b>
				<input type="checkbox"/> 240	<input type="checkbox"/> WM ..... (TO FIT OVER 2 7/8" O.D.)		
				<input type="checkbox"/> 277			
				<input type="checkbox"/> 347			
				<input type="checkbox"/> 480			
						FOR SMOOTH FINISH REPLACE SUFFIX "T" WITH SUFFIX "S" (EXAMPLE: RAL-9500-S)	
						SEE USALTG.COM FOR ADDITIONAL COLORS	

NOTE:  
1 - NOT AVAILABLE IN 525mA

# AEROLUME SERIES - LED

## LAMP/ELECTRICAL GUIDE

LED COUNT	SOURCE TYPE	SOURCE	INITIAL LUMENS - 4000K	INITIAL LUMENS - 3000K	INITIAL LUMENS - 5000K	L70 GREATER THAN (HR)	STARTING TEMP.	SYSTEM WATTS	VOLTS	MAX INPUT AMPS
48	LED	48 ✓LED* Optical Module - 350mA	4,241 - 4,760	3,731 - 4,187	4,337 - 4,868	60,000+	-20°F	55	120 277 347	0.46 0.20 0.16
48	LED	48 ✓LED* Optical Module - 525mA	5,871 - 6,557	5,152 - 5,755	6,009 - 6,711	60,000+	-20°F	79	120 277 347	0.66 0.29 0.23
64	LED	64 ✓LED* Optical Module - 350mA	5,255 - 5,898	4,623 - 5,189	5,373 - 6,031	60,000+	-20°F	70	120 277 347	0.59 0.26 0.21
64	LED	64 ✓LED* Optical Module - 525mA	7,393 - 8,257	6,488 - 7,246	7,566 - 8,451	60,000+	-20°F	108	120 277 347	0.90 0.39 0.32
80	LED	80 ✓LED* Optical Module - 350mA	7,131 - 7,452	6,273 - 6,556	7,292 - 7,620	60,000+	-20°F	85	120 277 347	0.77 0.31 0.25
80	LED	80 ✓LED* Optical Module - 525mA	9,994 - 10,444	8,770 - 9,166	10,228 - 10,689	60,000+	-20°F	130	120 277 347	1.09 0.47 0.38
100	LED	120 ✓LED* Optical Module - 350mA	8,862 - 9,620	7,796 - 8,146	9,062 - 9,469	60,000+	-20°F	109	120 277 347	0.91 0.40 0.32
120	LED	120 ✓LED* Optical Module - 350mA	10,634 - 11,112	9,355 - 9,776	10,874 - 11,363	60,000+	-20°F	130	120 277 347	1.09 0.47 0.38

### NOTES:

1. Max Input Amps is the highest of starting, operating, or open circuit currents
2. Lumen values for LED Modules vary according to the distribution type
3. System Watts includes the source watts and all driver components.
4. Fuse value should be sufficient to protect all wiring components. For electronic driver and LED component protection, use 10KV - 20KV surge suppressors.
5. L70(9K) - TM-21 6x rule applied

**WARNING:** All fixtures must be installed in accordance with local codes or the National Electrical Code. Failure to do so may result in serious personal injury.