

# SOLID STATE AREA LIGHTING

## CTR SERIES-LED

### SPECIFICATIONS

#### LUMINAIRE

Prismatic borosilicate glass refracting lens with specular top reflector. Heavy gauge, corrosion resistant cast aluminum housing. Top is hinged for access. Luminaire base has 3" I.D. opening for tenon. All hardware is stainless steel.

#### LED POWER ARRAY™

Three-dimensional array of individual LED Tubes fastened to a retaining plate. Each LED Tube consists of circuit board populated with a multiple of LED's and is mechanically fastened to a radial aluminum heat sink. An acrylic lens and end cap protects the LED Tube's internal components.

#### VERTICAL POWER™ ARRAY WITH REFRACTING

**GLOBE:** LED Tubes are aligned vertically and arranged radially to produce an even raw light distribution that simulates standard light sources. Used in conjunction with the external prismatic refracting lens which provides the optical control.

#### LED EMITTERS

High Output LED's are driven at 350mA for nominal 1 Watt output each. LED's are available in standard Neutral White (4000K), or optional Cool White (5000K) or Warm White (3000K). Consult factory for other LED options.

#### LED DRIVER

UL and CUL recognized High Power Factor, Constant Current LED drivers operate on input voltages from 120-277VAC, 50/60hz. Consult Factory for (347-480VAC). Driver is mechanically fastened to a retaining bracket. Main Power quick disconnect provided. Driver has a minimum 4KV of internal surge protection, 10KV & 20KV Surge Protector optional. Dimming and High-Low Driver options available.

#### FINISH

Polyester powder coat incorporates four step iron phosphate process to pretreat metal surface for maximum adhesion. Top coat is baked at 400°F for maximum hardness and exterior durability.

PROJECT NAME: \_\_\_\_\_

PROJECT TYPE: \_\_\_\_\_



**CTR\***

\*CTRN SHOWN

PATENT PENDING

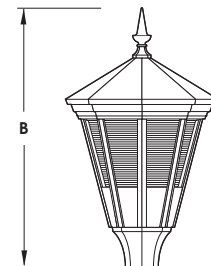
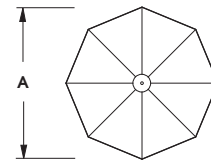

FIXTURE	A	B
CTRN	19.5" 495mm	31" 787mm
CTRH	21" 533mm	32.5" 826mm
CTRR	19.5" 495mm	32.5" 826mm



2013135

# CTR SERIES - LED

## S P E C I F I C A T I O N S

### OPTIONAL STYLES

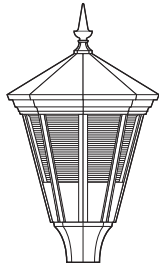

CTRN

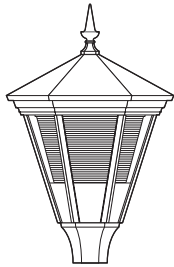

CTRH

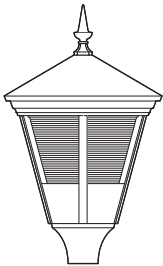

CTRR

### WALL MOUNT

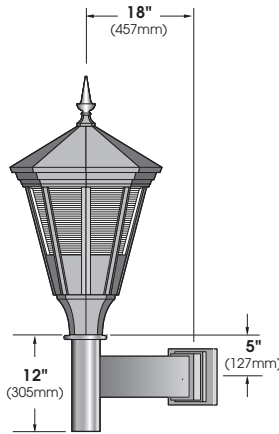

EXTRUDED ALUMINUM ARM BRACKET AND CAST ALUMINUM WALL BRACKET ASSEMBLY PROVIDED WITH BUILT IN GASKETED WIRE ACCESS FOR FIXTURE/SUPPLY WIRE CONNECTION.

### WALL PLATE

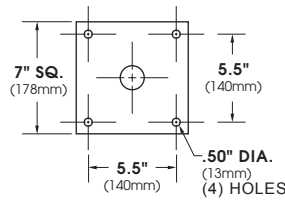

### LED POWER ARRAY™ MODULES



**CTR-LED** E.P.A.= 1.45

Available in:  
6 Array 48LED Max.  
8 Array 64LED Max.  
10 Array 80LED Max.



**CTRH-LED** E.P.A.= 1.53

Available in:  
6 Array 48LED Max.  
8 Array 64LED Max.  
10 Array 80LED Max.

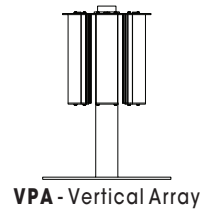

VPA - Vertical Array



**CTRR-LED** E.P.A.= 1.49

Available in:  
6 Array 48LED Max.  
8 Array 64LED Max.  
10 Array 80LED Max.

PATENT PENDING

## O R D E R I N G I N F O R M A T I O N

LUMINAIRE	OPTICS	# of LED's	COLOR	VOLTAGE	MOUNTING	FINISH	OPTIONS
<b>LUMINAIRE</b>	<b>OPTICS</b>	<b>LED</b>			<b>MOUNTING</b>	<b>FINISH</b>	<b>OPTIONS</b>
LUMINAIRE	VERTICAL POWER ARRAY (CLEAR PRISMATIC GLOBE)	# of LEDs	COLOR	VOLTAGE	ARM MOUNT	STANDARD TEXTURED FINISH	
<input type="checkbox"/> CTRN-LED	<input type="checkbox"/> VPA - III .....	<input type="checkbox"/> 80LED (90 Watts)	<input type="checkbox"/> NW (4000K)* *STANDARD	<input type="checkbox"/> 120	<input type="checkbox"/> 1 .....	<input type="checkbox"/> BLACK RAL-9005-T	<input type="checkbox"/> HOUSE SIDE SHIELD...HS
<input type="checkbox"/> CTRH-LED	<input type="checkbox"/> VPA - V .....	<input type="checkbox"/> 64LED (71 Watts)	<input type="checkbox"/> CW (5000K)	<input type="checkbox"/> 208	<input type="checkbox"/> 2-180 .....	<input type="checkbox"/> WHITE RAL-9003-T	<input type="checkbox"/> DIMMABLE DRIVER(S) (0-10V)..... DIM
<input type="checkbox"/> CTRR-LED		<input type="checkbox"/> 48LED (53 Watts)	<input type="checkbox"/> WW (3000K)	<input type="checkbox"/> 240	<input type="checkbox"/> 2-90 .....	<input type="checkbox"/> GREY RAL-7004-T	<input type="checkbox"/> HIGH-LOW DIMMING FOR HARDWIRED SWITCHING OR NON-INTEGRATED MOTION SENSOR..... HLSW
		<input type="checkbox"/> 36LED (41 Watts)	OTHER LED COLORS AVAILABLE CONSULT FACTORY	<input type="checkbox"/> 277	<input type="checkbox"/> 3-90 .....	<input type="checkbox"/> DARK BRONZE RAL-8019-T	<input type="checkbox"/> PHOTO CELL + VOLTAGE (EXAMPLE: PC120V) ... PC+V
		Wattages are Max Input Watts		<input type="checkbox"/> 347	<input type="checkbox"/> 3-120 .....	<input type="checkbox"/> GREEN RAL-6005-T	<input type="checkbox"/> 10KV SURGE PROTECTOR..... 10SP
				<input type="checkbox"/> 480	<b>WALL MOUNT</b>	FOR SMOOTH FINISH REMOVE SUFFIX "T" (EXAMPLE: RAL-9500)	<input type="checkbox"/> 20KV SURGE PROTECTOR (277V & 480V Only) ... 20SP
					<input type="checkbox"/> WM .....	SEE USALTG.COM FOR ADDITIONAL COLORS	
					<b>POST TOP</b>		
					<input type="checkbox"/> PT .....		