

G S B P T 3

[250 WATT MAX.]

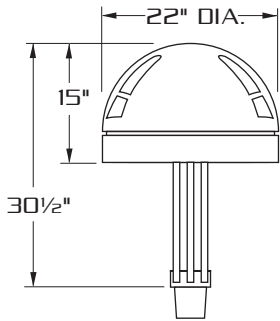

SIDE VIEW

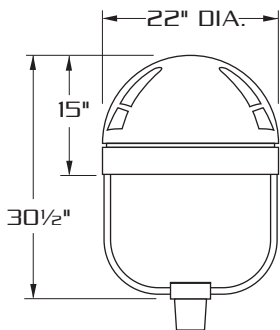

FRONT VIEW

E.P.A. = 1.55

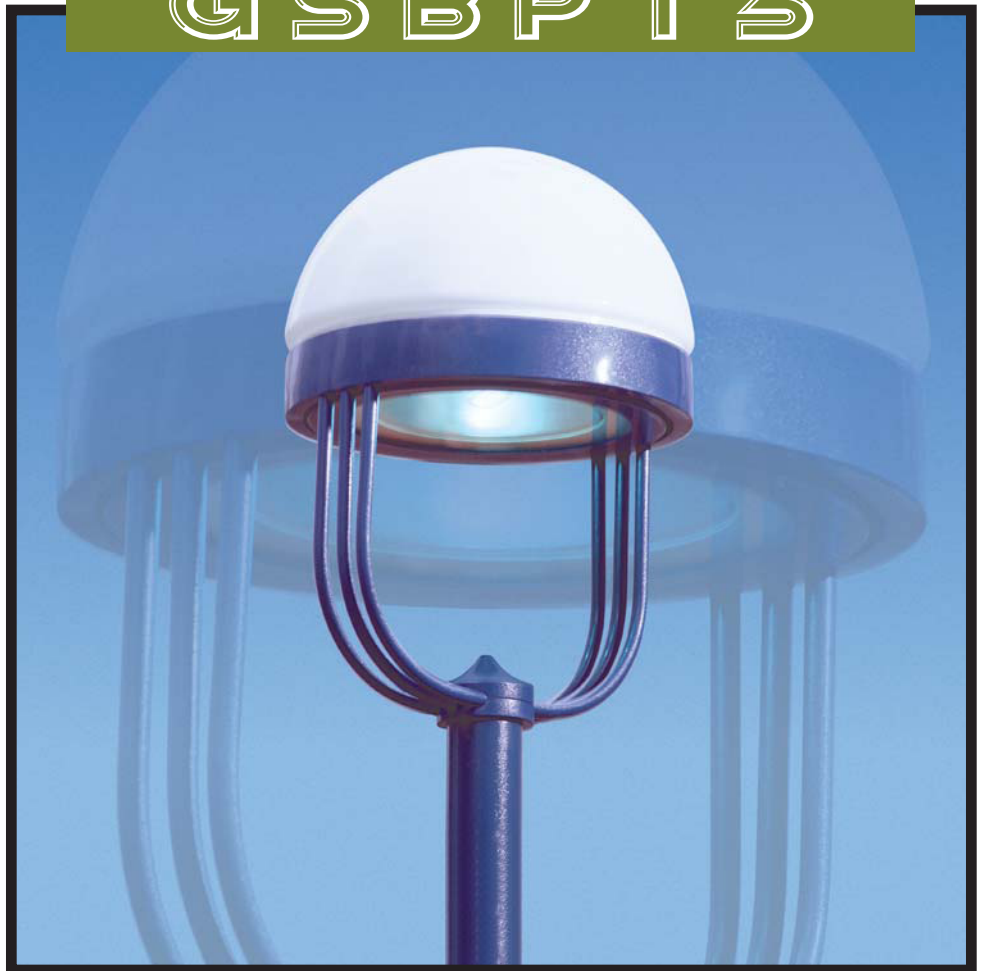

SPECIFICATIONS

- HOUSING:** ONE PIECE HEAVY WALL SPUN ALUMINUM HOUSING. MOLDED WHITE TRANSLUSCENT ACRYLIC DOME WITH INTERNAL GLASS DIFFUSER PROVIDES SOFT UNIFORM UPLIGHT.
- LENS ASS'Y:** ONE PIECE HINGED HEAVY WALL DIE FORMED ALUMINUM DOOR FRAME SURROUNDS 3/16" CLEAR TEMPERED GLASS LENS. GLASS IS SEALED TO DOOR WITH HIGH TEMPERATURE SILICONE SEAL. CAPTIVE THUMB SCREW DISENGAGES LENS ASSEMBLY AND ACTIVATES ACCUHINGE™ HINGE TO ALLOW LENS ASSEMBLY TO HINGE AWAY FROM HOUSING FOR LUMINAIRE ACCESS WITHOUT THE USE OF TOOLS.
- OPTICS:** COMPUTER DESIGNED ONE PIECE SEMI SPECULAR HYDROFORMED REFLECTOR. COMBINES WITH CLEAR TEMPERED GLASS LENS TO PRODUCE A HIGHLY EFFICIENT, SHARP CUTOFF. IMPACT RESISTANT ACRYLIC DOME SURROUNDS INTERNAL OPAL GLASS DIFFUSER TO PROVIDE SOFT UNIFORM UPLIGHT.
- GASKETING:** CLOSED CELL EPDM GASKETING COMPRESSED BETWEEN DOOR AND HOUSING WORKS IN COMBINATION WITH ACCUHINGE™ HINGE TO PRESSURE SEAL OPTICAL CHAMBER.
- LAMP HOLDER:** MOGUL BASE PORCELAIN.
- LAMP:** (BY OTHERS)
- BALLAST:** H.P.F./C.W.A. AUTOTRANSFORMER. -20° STARTING TEMPERATURE. ELECTRICAL COMPONENTS ARE MOUNTED TO HINGED, REMOVABLE TRAY.
- ARM:** SIX (6) EXTRUDED ALUMINUM (.84 O.D.) ARMS WELDED TO A CAST ALUMINUM POLE TOP FITTER. ARMS ARE INTERNALLY WELDED TO HOUSING.
- FINISH:** POLYESTER POWDER COAT-STATE OF THE ART 20 PSI PRESSURE POWER WASH AT 140° TEMPERATURE INCORPORATES FOUR STEP IRON PHOSPHATE PROCESS TO CLEANSE AND PRETREAT THE METAL SURFACE FOR MAXIMUM PAINT ADHESION. ELECTROSTATICALLY APPLIED TEXTURED POLYESTER POWDER TOPCOAT IS BAKED AT 400° TEMPERATURE FOR MAXIMUM HARDNESS AND EXTERIOR DURABILITY.



MOUNTING STYLES

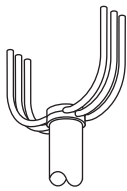

PTA

STANDARD TENON ASSEMBLY FOR 4" & 5" DIA. POLES.

DECORATIVE RING SUPPLIED FOR 6" DIA. POLES. [SPECIFY POLE I.D.]

POLE REQUIRED			
	4" DIA.	5" DIA.	6" DIA.
HPS	70-100	150	200-250
MH	70	100-175	200-250
MV	75	100-175	250

BALLAST IS MOUNTED INSIDE POLE

WALL MOUNT

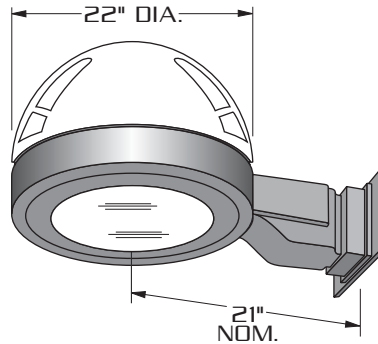

CORROSION RESISTANT CAST ALUMINUM CONSTRUCTION. ARM IS SUPPLIED WITH REMOVABLE CAST ALUMINUM TOP CAP FOR EASY ACCESS TO ELECTRICAL COMPONENTS.

WALL PLATE

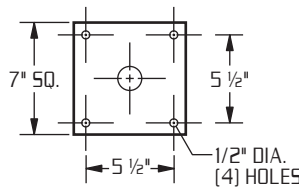

**LAMP SIZE:
70 - 250 WATT**

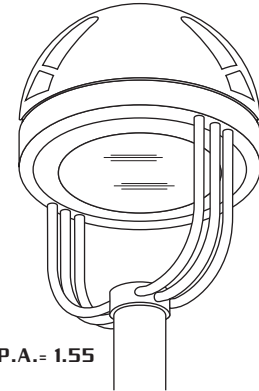

E.P.A.= 1.55

OPTICAL SYSTEMS ENCLOSED IN IMPACT RESISTANT TEMPERED GLASS DIFFUSER.

SOFT UNIFORM UPLIGHT.

ORDERING INFORMATION

MODEL NO.:	OPTICS	WATTAGE TYPE VOLTAGE	MOUNTING	FINISH	OPTIONS
GSBPT3					
MODEL NO.:	OPTICS	LAMP	MOUNTING	FINISH	OPTIONS
G S B P T 3	<input type="checkbox"/> TYPE III III..... (hydroform)	<input type="checkbox"/> 250 <input type="checkbox"/> HPS <input type="checkbox"/> 120	 <input type="checkbox"/> PTA WALL MOUNT <input type="checkbox"/> WM	<input type="checkbox"/> STANDARD TEXTURED FINISH	<input type="checkbox"/> CLEAR POLYCARBONATE DIFFUSERLEX
	<input type="checkbox"/> TYPE IV (FORWARD THROW) IV..... (segmented)	<input type="checkbox"/> 200 <input type="checkbox"/> MH <input type="checkbox"/> 208		<input type="checkbox"/> BLACK RAL-9005-T	<input type="checkbox"/> HOUSE SIDE SHIELDHS
	<input type="checkbox"/> TYPE V V..... 	<input type="checkbox"/> 175 <input type="checkbox"/> MV <input type="checkbox"/> 240		<input type="checkbox"/> WHITE RAL-9003-T	<input type="checkbox"/> PHOTO CELL + VOLTAGE (EXAMPLE: PC120V)PC+V
	<input type="checkbox"/> 150 <input type="checkbox"/> 277	<input type="checkbox"/> 100 <input type="checkbox"/> 480		<input type="checkbox"/> GREY RAL-7004-T	<input type="checkbox"/> TWIST LOCK PHOTO CELL+VOLTAGE (EXAMPLE TPC120V)TPC+V
	<input type="checkbox"/> 75 <input type="checkbox"/> 250	<input type="checkbox"/> 70 <input type="checkbox"/> MT		<input type="checkbox"/> DRK BRONZE RAL-8019-T	<input type="checkbox"/> TWIST LOCK RECEPTACLE ONLYTPR
				<input type="checkbox"/> GREEN RAL-6005-T	<input type="checkbox"/> SINGLE FUSE (120V., 277V)SF
					<input type="checkbox"/> DOUBLE FUSE (208V., 240V)DF
					<input type="checkbox"/> TAMPER PROOFTP
		METAL HALIDE UNITS ONLY USE ED28 LAMP FOR 250 W. USE MEDIUM BASE LAMP FOR 100 W.		FOR SMOOTH FINISH REMOVE SUFFIX "T" (EXAMPLE: RAL-9500) SEE WEBSITE FOR ADDITIONAL COLORS	