

SOLID STATE AREA LIGHTING

RCGN SERIES-LED

SPECIFICATIONS

LUMINAIRE

One piece high impact polycarbonate globe provided with durable corrosion resistant cast aluminum fitter and cage. Standard fitter has 3" I.D. opening for tenon. All hardware is Stainless Steel.

LED POWER ARRAY™

Three-dimensional array of individual LED Tubes fastened to a retaining plate. Each LED Tube consists of circuit board populated with a multiple of LED's and is mechanically fastened to a radial aluminum heat sink. An acrylic Lens and end cap protects the LED Tube's internal components.

VERTICAL POWER ARRAY™ WITH GLASS REFRACTOR:

LED Tubes are aligned vertically and arranged radially to produce an even raw light distribution that simulates standard light sources. Array is secured within a 6" Prismatic Glass Refractor which provides the optical control. Used in conjunction with a clear smooth globe.

VERTICAL POWER ARRAY™: LED Tubes are aligned vertically and arranged radially to produce an even raw light distribution that simulates standard light sources. Produces a minimal glare, symmetric diffuse light distribution. Used in conjunction with an opal smooth diffusing globe.

LED EMITTERS

High Output LED's are driven at 350mA for nominal 1 Watt output each. LED's are available in standard Neutral White (4000K), or optional Cool White (5000K) or Warm White (3000K). Consult Factory for other LED options.

LED DRIVER

UL and CUL recognized High Power Factor, Constant Current LED drivers operate on input voltages from 120-277VAC, 50/60hz. Consult Factory for 347-480VAC. Driver is mechanically fastened to a retaining bracket. Main power quick disconnect provided. Driver has a minimum 4KV of internal surge protection, 10KV & 20KV Surge Protector optional. Dimming and High-Low Driver options available.

FINISH

Polyester powder coat incorporates four step iron phosphate process to pretreat metal surface for maximum adhesion. Top coat is baked at 400°F for maximum hardness and exterior durability.

PROJECT NAME: _____

PROJECT TYPE: _____



RCGN

PATENT PENDING

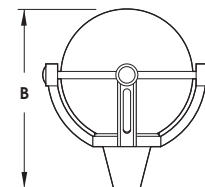
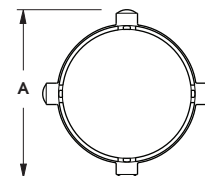

FIXTURE	A	B
RCGN22	28" 711mm	30" 762mm
RCGN18	23 584mm	24" 610mm
RCGN14	18.5" 470mm	19.5" 495mm



2014238

RCGN SERIES - LED

S P E C I F I C A T I O N S

WALL MOUNT

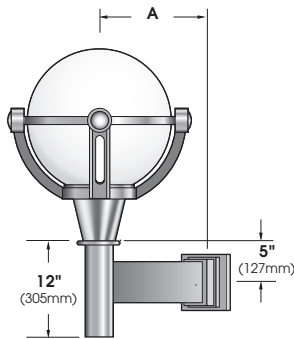

A		
RCGN22	RCGN18	RCGN14
15" 381mm	13" 330mm	11" 279mm

ARM BRACKET EXTRUDED AND CAST ALUMINUM CONSTRUCTION.

WALL PLATE

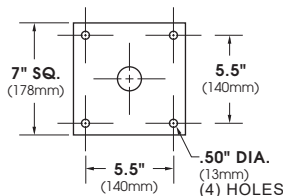

LED POWER ARRAY™ MODULES

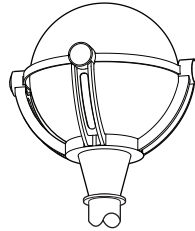

RCGN22-LED
E.P.A. = 2.42

**GLASS REFRACTOR w/
VERTICAL ARRAY**
Available in:
6 Array 36 LED Max.

VERTICAL ARRAY
Available in:
8 Array 64 LED Max.

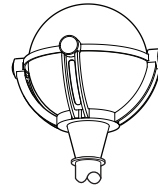

RCGN18-LED
E.P.A. = 1.62

**GLASS REFRACTOR w/
VERTICAL ARRAY**
Available in:
6 Array 36 LED Max.

VERTICAL ARRAY
Available in:
6 Array 48 LED Max.

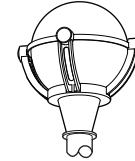

RCGN14-LED
E.P.A. = 1.04

**GLASS REFRACTOR w/
VERTICAL ARRAY**
Available in:
6 Array 36 LED Max..

VERTICAL ARRAY
Available in:
6 Array 36 LED Max.

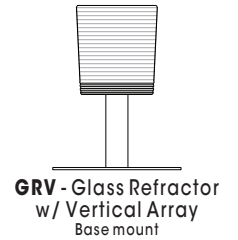

**GRV - Glass Refractor
w/ Vertical Array
Base mount**

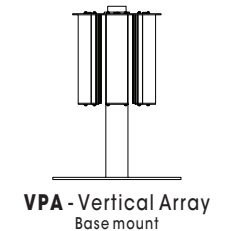

**VPA - Vertical Array
Base mount**

Spec/Order Example: RCGN14-LED/GRV-III/36WW347/2-180/RAL8019-T/WA

S P E C / O R D E R I N G I N F O R M A T I O N

LUMINAIRE-FITTER	OPTICS	# of LED's	COLOR	VOLTAGE	MOUNTING	FINISH	OPTIONS
LUMINAIRE	OPTICS	LED			MOUNTING	FINISH	OPTIONS
LUMINAIRE-FITTER	GLASS REFRACTOR (CLEAR SMOOTH GLOBE)	# of LEDs	COLOR		ARM MOUNT	STANDARD TEXTURED FINISH	LENS OPTIONS:
<input type="checkbox"/> RCGN22-LED	<input type="checkbox"/> GRV - III	RCGN22 <input type="checkbox"/> 36LED (40 Watts)	<input type="checkbox"/> NW (4000K)* *STANDARD		<input type="checkbox"/> 1	<input type="checkbox"/> BLACK RAL-9005-T	<input type="checkbox"/> CLEAR SMOOTH ACRYLIC CA
<input type="checkbox"/> RCGN18-LED	<input type="checkbox"/> GRV - V	<input type="checkbox"/> 36LED (40 Watts)	<input type="checkbox"/> CW (5000K)		<input type="checkbox"/> 2-180	<input type="checkbox"/> WHITE RAL-9003-T	<input type="checkbox"/> OPAL SMOOTH ACRYLIC WA
<input type="checkbox"/> RCGN14-LED		RCGN14 <input type="checkbox"/> 36LED (40 Watts)	<input type="checkbox"/> WW (3000K)		<input type="checkbox"/> 2-90	<input type="checkbox"/> GREY RAL-7004-T	<input type="checkbox"/> CLEAR SMOOTH POLYCARBONATE . . . CP
		Wattages are Max Input Watts	OTHER LED COLORS AVAILABLE CONSULT FACTORY		<input type="checkbox"/> 3-90	<input type="checkbox"/> DARK BRONZE RAL-8019-T	<input type="checkbox"/> OPAL SMOOTH POLYCARBONATE . . . WP
	VERTICAL POWER ARRAY (OPAL ACRYLIC STANDARD)	RCGN22 <input type="checkbox"/> 64LED (72 Watts) <input type="checkbox"/> 48LED (53 Watts) <input type="checkbox"/> 36LED (40 Watts)	VOLTAGE <input type="checkbox"/> 120 <input type="checkbox"/> 208 <input type="checkbox"/> 240 <input type="checkbox"/> 277 <input type="checkbox"/> 347 <input type="checkbox"/> 480		<input type="checkbox"/> 3-120	<input type="checkbox"/> GREEN RAL-6005-T	<input type="checkbox"/> HOUSE SIDE SHIELD . . . HS
	<input type="checkbox"/> VPA - SYM	RCGN18 <input type="checkbox"/> 48LED (53 Watts) <input type="checkbox"/> 36LED (40 Watts)			<input type="checkbox"/> 4-90		<input type="checkbox"/> DIMMABLE DRIVER(S) (0-10V) DIM
		Wattages are Max Input Watts			WALL MOUNT <input type="checkbox"/> WM	FOR SMOOTH FINISH REPLACE SUFFIX "T" WITH SUFFIX "S" (EXAMPLE: RAL-9500-S)	<input type="checkbox"/> HIGH-LOW DIMMING FOR HARDWIRED SWITCHING OR NON-INTEGRATED MOTION SENSOR HLSW
		Wattages are Max Input Watts			POST TOP <input type="checkbox"/> PT	SEE USALTG.COM FOR ADDITIONAL COLORS	<input type="checkbox"/> PHOTO CELL + VOLTAGE (EXAMPLE: PC120V) . . . PC+V
							<input type="checkbox"/> 10KV SURGE PROTECTOR 10SP
							<input type="checkbox"/> 20KV SURGE PROTECTOR (277V & 480V Only) 20SP