

H.I.D. AREA LIGHTING

RSB SERIES-HID

S P E C I F I C A T I O N S

HOUSING and MOUNTING ARM

Heavy wall spun aluminum construction. Entire housing surface shall be free of welds or seams. 3"x5"x6" long heavy wall extruded aluminum arm is secured to housing and to pole with stainless steel rods.

LENS ASSEMBLY

One piece hinged heavy gauge die formed aluminum door frame surrounds 3/16" clear tempered flat glass lens. Glass is sealed to door with high temperature silicone seal. Captive thumb screw disengages lens assembly and activates Accuhinge™ hinge to allow lens assembly to hinge away from housing for luminaire access without the use of tools

REFLECTOR MODULE

Specular Alzak® optical segments rigidly mounted in an aluminum frame, which attaches to the housing as a one piece module. Reflector module is field rotatable in 90° increments and may be rotated or removed without the use of tools. Reflector modules are factory prewired with a quick-disconnect plug. Sockets are porcelain 4KV pulse rated, medium base (E26) for 50W - 150W or bi-pin (G12) for 70W and 150W; mogul base (E39) for 200W; pin oriented mogul base (E39) for 200W - 400W. Special for 210W and 315W CDM Elite lamp base is PGZ18. Lamp is horizontally mounted.

ELECTRICAL COMPONENTS

All electrical components are UL and cUL recognized mounted on a single plate and factory wired with quick-disconnect. Electrical module attaches to housing with toolless hinge and latch. Electronic MH ballasts have power factor of >.95, -20°F starting, 120-277V 50Hz/60Hz and have lamp End-of-life protection. Special for Philips MasterColor CDM Elite: Electronic MH ballast has a power factor of >.90 (210W & 315W), -4°F starting, 200 - 277V, 50Hz/60Hz and has lamp End-of-life protection. 315W electronic MH ballast has 0 - 10V dimming capability. Magnetic MH ballasts are high power factor (70W - 150W) or CWA (250W), -20°F starting, multi-tap 120-277V, 60Hz. All HPS ballasts are core and coil, high-reactance, high power factor (70W - 150W) or CWA (200W - 400W), -40°F starting.

FINISH

Electrostatically applied TGIC Polyester Powder Coat on substrate prepared with 20 PSI power wash at 140° F. Four step iron phosphate pretreatment for protection and paint adhesion. 400°F bake for maximum hardness and durability. Texture finish is standard.

PROJECT NAME: _____

FIXTURE TYPE: _____



RSB

PATENT PENDING

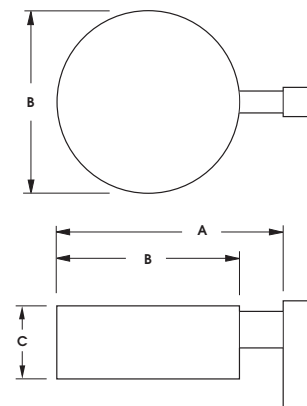

FIXTURE	A	B	C
RSB25	31" 784mm	25" 635mm	11" 279mm
RSB18	24" 609mm	18" 457mm	10" 254mm

RSB SERIES - HID

S P E C I F I C A T I O N S

POLE DRILLING TEMPLATE

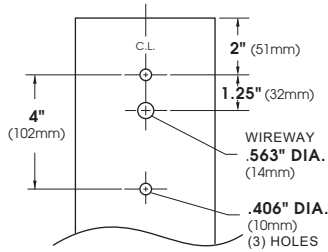

WALL MOUNT

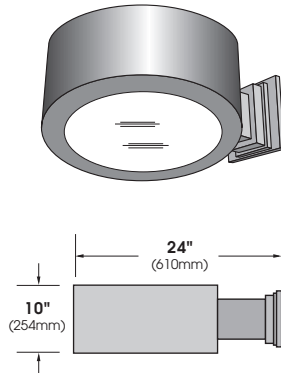

ARM BRACKET EXTRUDED AND CAST ALUMINUM CONSTRUCTION.

WALL PLATE

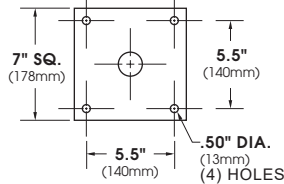

LAMP WATTAGE

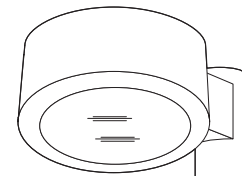
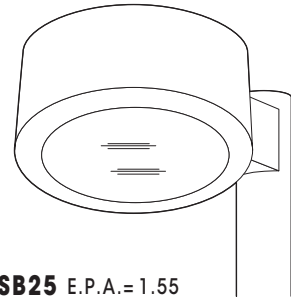

Spec/Order Example: RSB25-IV/400PSMH480/2-90/RAL-7004-S/DF

S P E C / O R D E R I N G I N F O R M A T I O N

MODEL	WATTAGE	TYPE	VOLTAGE	OPTICS	MOUNTING	FINISH	OPTIONS
MODEL	LAMP			OPTICS	MOUNTING	FINISH	OPTIONS
STANDARD FLAT GLASS LENS	STANDARD MAGNETIC BALLAST				ARM MOUNT	STANDARD TEXTURED FINISH	
<input type="checkbox"/> RSB25	<input type="checkbox"/> 400 ⁴ <input type="checkbox"/> 350 ⁴ <input type="checkbox"/> 320 ⁴ <input type="checkbox"/> 315 ⁵ <input type="checkbox"/> 250 <input type="checkbox"/> 210 ⁵ <input type="checkbox"/> 200 ³ <input type="checkbox"/> 175 ³ <input type="checkbox"/> 150T ² <input type="checkbox"/> 150 <input type="checkbox"/> 100	<input type="checkbox"/> PSMH <input type="checkbox"/> HPS <input type="checkbox"/> 120 <input type="checkbox"/> 208 <input type="checkbox"/> 240 <input type="checkbox"/> 277 <input type="checkbox"/> 347 (CAN) <input type="checkbox"/> 480		<input type="checkbox"/> TYPE II HR-II <input type="checkbox"/> TYPE III HR-III <input type="checkbox"/> TYPE IV HR-IV (FORWARD THROW)	<input type="checkbox"/> 1 <input type="checkbox"/> 2-180 <input type="checkbox"/> 2-90 <input type="checkbox"/> 3-90 <input type="checkbox"/> 3-120 <input type="checkbox"/> 4-90	<input type="checkbox"/> BLACK RAL-9005-T <input type="checkbox"/> WHITE RAL-9003-T <input type="checkbox"/> GREY RAL-7004-T <input type="checkbox"/> DARK BRONZE RAL-8019-T <input type="checkbox"/> GREEN RAL-6005-T	HOUSE SIDE SHIELD <input type="checkbox"/> 90 HS 90° <input type="checkbox"/> 135 HS 135° <input type="checkbox"/> 180 HS 180° <input type="checkbox"/> PHOTO CELL + VOLTAGE (EXAMPLE: PC120V) PC+V <input type="checkbox"/> SINGLE FUSE (120V, 277V) SF <input type="checkbox"/> DOUBLE FUSE (208V, 240V, 480V) DF <input type="checkbox"/> HIGH-LOW DIMMING FOR HARDWIRED SWITCHING OR NON-INTEGRATED MOTION SENSOR HLSW <input type="checkbox"/> COVEX GLASS CG
<input type="checkbox"/> RSB18	<input type="checkbox"/> E ¹ (ELECTRONIC)			<input type="checkbox"/> TYPE V-SQ HR-V-SQ <input type="checkbox"/> FORWARD THROW (HOUSE SIDE CUT-OFF) HR - FT -HSC	<input type="checkbox"/> WM WALL MOUNT <input type="checkbox"/> PT POST TOP	FOR SMOOTH FINISH REPLACE SUFFIX "T" WITH SUFFIX "S" (EXAMPLE: RAL-9500-S) SEE USALTG.COM FOR ADDITIONAL COLORS	
FOR CONVEX LENS USE "CG" SELECTION IN OPTIONS COLUMN	STANDARD MAGNETIC BALLAST						
	<input type="checkbox"/> 150T ² <input type="checkbox"/> 150 <input type="checkbox"/> 100 <input type="checkbox"/> 70T ² <input type="checkbox"/> 70 <input type="checkbox"/> 50	<input type="checkbox"/> PSMH <input type="checkbox"/> HPS <input type="checkbox"/> 120 <input type="checkbox"/> 208 <input type="checkbox"/> 240 <input type="checkbox"/> 277 <input type="checkbox"/> 347 (CAN) <input type="checkbox"/> 480					
	<input type="checkbox"/> E ¹ (ELECTRONIC)						
	CONSULT FACTORY FOR OTHER BALLAST CONFIGURATIONS AND LAMP OPTIONS						