

# H.I.D. AREA LIGHTING

## RSBPT SERIES-HID

### S P E C I F I C A T I O N S

#### HOUSING

Heavy wall spun aluminum construction. Entire housing surface shall be free of welds or seams. 3"x5"x6" long heavy wall extruded aluminum arm is secured to housing and to pole with stainless steel rods.

#### ARM

Four (6) extruded aluminum (.84" O.D.) arms welded to a cast aluminum pole top fitter. Arms are internally welded to housing.

#### LENS ASSEMBLY

One piece hinged heavy gauge die formed aluminum door frame surrounds 3/16" clear tempered flat glass lens. Glass is sealed to door with high temperature silicone seal. Captive thumb screw disengages lens assembly and activates Accuhinge™ hinge to allow lens assembly to hinge away from housing for luminaire access without the use of tools

#### REFLECTOR MODULE

Specular Alzak® optical segments rigidly mounted in an aluminum frame, which attaches to the housing as a one piece module. Reflector module is field rotatable in 90° increments and may be rotated or removed without the use of tools. Reflector modules are factory prewired with a quick-disconnect plug. Sockets are porcelain 4KV pulse rated, medium base (E26) for 50W - 150W or bi-pin (G12) for 70W and 150W; mogul base (E39) for 200W; pin oriented mogul base (E39) for 200W - 400W. Special for 210W and 315W CDM Elite lamp base is PGZ18. Lamp is horizontally mounted.

#### ELECTRICAL COMPONENTS

All electrical components are UL and cUL recognized mounted on a single plate and factory wired with quick-disconnect. Electrical module attaches to housing with toolless hinge and latch. Electronic MH ballasts have power factor of >.95, -20°F starting, 120-277V 50Hz/60Hz and have lamp End-of-life protection. Special for Philips MasterColor CDM Elite: Electronic MH ballast has a power factor of >.90 (210W & 315W), -4°F starting, 200 - 277V, 50Hz/60Hz and has lamp End-of-life protection. 315W electronic MH ballast has 0 - 10V dimming capability. Magnetic MH ballasts are high power factor (70W - 150W) or CWA (250W), -20°F starting, multi-tap 120-277V, 60Hz. All HPS ballasts are core and coil, high-reactance, high power factor (70W - 150W) or CWA (200W - 400W), -40°F starting.

#### FINISH

Electrostatically applied TGIC Polyester Powder Coat on substrate prepared with 20 PSI power wash at 140° F. Four step iron phosphate pretreatment for protection and paint adhesion. 400°F bake for maximum hardness and durability. Texture finish is standard.

PROJECT NAME: \_\_\_\_\_

FIXTURE TYPE: \_\_\_\_\_



**RSBPT**

PATENT PENDING

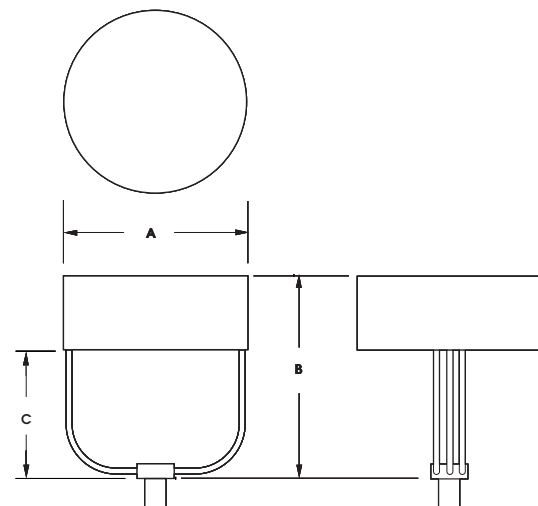

FIXTURE	A	B	C
<b>RSBPT325</b>	24.5" 622mm	25.5" 762mm	19.5" 495mm
<b>RSBPT318</b>	18" 457mm	25.5" 635mm	15.5" 394mm

 Light Pollution Control Classification System  
Full cutoff 0% Uplight Luminaire

 U.L. Listed for wet location

MADE IN THE  
**USA**

2016123

U.S. Architectural Lighting

660 West Avenue O, Palmdale, CA 93551  
Phone (661) 233-2000 Fax (661) 233-2001  
www.usallg.com

**U.S. ARCHITECTURAL**  
**LIGHTING**

# RSBPT SERIES - HID

## SPECIFICATIONS

### POLE DRILLING TEMPLATE

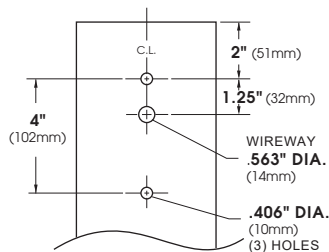

### WALL MOUNT

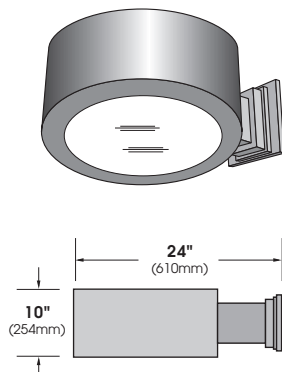

ARM BRACKET EXTRUDED AND CAST ALUMINUM CONSTRUCTION.

### WALL PLATE

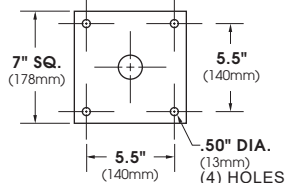

### E.P.A. & LAMP WATTAGE

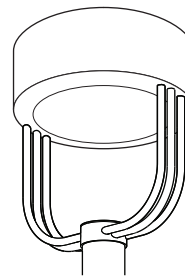

**RSBPT25** E.P.A. = 1.48  
LAMP SIZE: 100 - 400 WATT

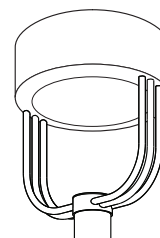

**RSBPT18** E.P.A. = 1.04  
LAMP SIZE: 50 - 150 WATT

Spec/Order Example: RSBPT18/150PSMH347/II/3-90/RAL-9005-T/SF

## SPEC / ORDERING INFORMATION

MODEL	WATTAGE	TYPE	VOLTAGE	OPTICS	MOUNTING	FINISH	OPTIONS
<b>MODEL</b>	<b>LAMP</b>			<b>OPTICS</b>	<b>MOUNTING</b>	<b>FINISH</b>	<b>OPTIONS</b>
STANDARD FLAT GLASS LENS	STANDARD MAGNETIC BALLAST				ARM MOUNT	STANDARD TEXTURED FINISH	
<input type="checkbox"/> RSBPT25	<input type="checkbox"/> 400 <sup>4</sup> <input type="checkbox"/> 350 <sup>4</sup> <input type="checkbox"/> 320 <sup>4</sup> <input type="checkbox"/> 315 <sup>5</sup> <input type="checkbox"/> 250 <input type="checkbox"/> 210 <sup>5</sup> <input type="checkbox"/> 200 <sup>3</sup> <input type="checkbox"/> 175 <sup>3</sup> <input type="checkbox"/> 150T <sup>2</sup> <input type="checkbox"/> 150 <input type="checkbox"/> 100	<input type="checkbox"/> PSMH <input type="checkbox"/> HPS <input type="checkbox"/> 120 <input type="checkbox"/> 208 <input type="checkbox"/> 240 <input type="checkbox"/> 277 <input type="checkbox"/> 347 (CAN) <input type="checkbox"/> 480		<input type="checkbox"/> TYPE II HR-II .....	<input type="checkbox"/> 1 .....	<input type="checkbox"/> BLACK RAL-9005-T  <input type="checkbox"/> WHITE RAL-9003-T  <input type="checkbox"/> GREY RAL-7004-T  <input type="checkbox"/> DARK BRONZE RAL-8019-T  <input type="checkbox"/> GREEN RAL-6005-T	HOUSE SIDE SHIELD <input type="checkbox"/> 90 ..... HS 90° <input type="checkbox"/> 135 ..... HS 135° <input type="checkbox"/> 180 ..... HS 180°  <input type="checkbox"/> PHOTO CELL + VOLTAGE (EXAMPLE: PC120V) ..... PC+V  <input type="checkbox"/> SINGLE FUSE (120V, 277V) ..... SF  <input type="checkbox"/> DOUBLE FUSE (208V, 240V, 480V) ..... DF  <input type="checkbox"/> HIGH-LOW DIMMING FOR HARDWIRED SWITCHING OR NON-INTEGRATED MOTION SENSOR ..... HLSW  <input type="checkbox"/> COVEX GLASS ..... CG
<input type="checkbox"/> RSBPT18	<input type="checkbox"/> E <sup>1</sup> (ELECTRONIC)			<input type="checkbox"/> TYPE III HR-III .....	<input type="checkbox"/> 2-180 ..... <input type="checkbox"/> 2-90 ..... <input type="checkbox"/> 3-90 ..... <input type="checkbox"/> 3-120 ..... <input type="checkbox"/> 4-90 .....	<input type="checkbox"/> TYPE IV HR-IV (FORWARD THROW)	FOR SMOOTH FINISH REPLACE SUFFIX "T" WITH SUFFIX "S" (EXAMPLE: RAL-9500-S)  SEE USALTG.COM FOR ADDITIONAL COLORS
FOR CONVEX LENS USE "CG" SELECTION IN OPTIONS COLUMN	STANDARD MAGNETIC BALLAST <input type="checkbox"/> 150T <sup>2</sup> <input type="checkbox"/> 150 <input type="checkbox"/> 100 <input type="checkbox"/> 70T <sup>2</sup> <input type="checkbox"/> 70 <input type="checkbox"/> 50	<input type="checkbox"/> PSMH <input type="checkbox"/> HPS <input type="checkbox"/> 120 <input type="checkbox"/> 208 <input type="checkbox"/> 240 <input type="checkbox"/> 277 <input type="checkbox"/> 347 (CAN) <input type="checkbox"/> 480		<input type="checkbox"/> TYPE V-SQ HR-V-SQ .....	<input type="checkbox"/> 3-120 ..... <input type="checkbox"/> 4-90 .....	<input type="checkbox"/> TYPE IV HR-IV (FORWARD THROW)	
	<input type="checkbox"/> E <sup>1</sup> (ELECTRONIC)			<input type="checkbox"/> FORWARD THROW (HOUSE SIDE CUT-OFF) HR - FT -HSC .....	WALL MOUNT <input type="checkbox"/> WM .....		
					POST TOP <input type="checkbox"/> PT .....		
	CONSULT FACTORY FOR OTHER BALLAST CONFIGURATIONS AND LAMP OPTIONS						