

# SIDE MOUNTED ARM

# XMR

## SPECIFICATIONS

PROJECT NAME: \_\_\_\_\_

PROJECT TYPE: \_\_\_\_\_

### MOUNTING

Extruded aluminum arm that bolts to the pole with 2 bolts. Fixture mounts to arm with 2 bolts through the side of the driver housing. A wiring harness is provided through the arm assembly terminating in the driver housing with quick-connects. All hardware is stainless steel.

### FINISH

Electrostatically applied TGIC Polyester Powder Coat on substrate prepared with 20 PSI power wash at 140°F. Four step media blast and iron phosphate pretreatment for protection and paint adhesion. 400°F bake for maximum hardness and durability.



## XMR\*

SHOWN WITH OPTIONAL DOME CAP

PATENT PENDING

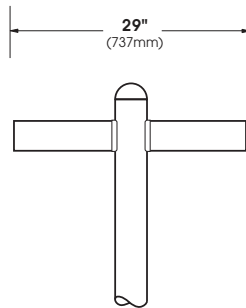

**XMR-2-180**  
EPA = 1.10

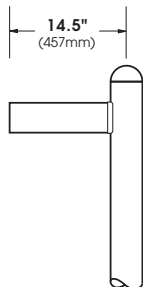

**XMR-1**  
EPA = 0.39

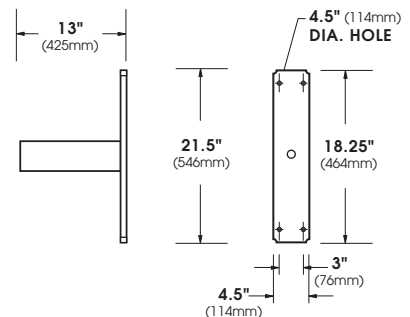

**XMR-WM**  
EPA = 0.52

SCALE: 1/2"=1'



2017166







# XMR

Spec/Order Example: XMR-2-180/RAL-8019-S

## S P E C / O R D E R I N G I N F O R M A T I O N

### CONFIGURATION

- |   |   |   |   |   |
|---|---|---|---|---|
|  |  |  |  |  |
| <input type="checkbox"/> XMR-WM   | <input type="checkbox"/> XMR-1  | <input type="checkbox"/> XMR-2-180  | <input type="checkbox"/> XMR-3-120  | <input type="checkbox"/> XMR-4-90   |

### FINISH\*

- |  |  |   |  |  |
|--|--|---|--|--|
| <input type="checkbox"/> BLACK<br>RAL-9005-T | <input type="checkbox"/> WHITE<br>RAL-9003-T | <input type="checkbox"/> GREY<br>RAL-7004-T | <input type="checkbox"/> DARK BRONZE<br>RAL-8019-T | <input type="checkbox"/> GREEN<br>RAL-6005-T |
|--|--|---|--|--|

\*STANDARD TEXTURED FINISH

FOR SMOOTH FINISH REPLACE SUFFIX "T" WITH SUFFIX "S"  
(EXAMPLE: RAL-9005-S)

CONSULT FACTORY FOR CUSTOM COLORS

