

SOLID STATE AREA LIGHTING

LAF SERIES-LED SPECIFICATIONS

LUMINAIRE

One piece high impact polycarbonate patterned diffusing globe provided with durable corrosion resistant cast aluminum fitter and ring. Standard fitter has 3" I.D. opening for tenon. All hardware is stainless steel.

LED POWER ARRAY™

Three-dimensional array of individual LED Tubes fastened to a retaining plate. Each LED Tube consists of circuit board populated with a multiple of LED's and is mechanically fastened to a radial aluminum heat sink. An acrylic Lens and end cap protects the LED Tube's internal components.

ANGLED POWER ARRAY™: Micro-Reflectors mounted around each LED control the raw light output. LED Tubes are uniquely aimed horizontally and vertically and combined to produce highly efficient IES Distribution Types II, III, IV and V. Used in conjunction with a clear patterned diffusing globe.

VERTICAL POWER ARRAY™ WITH GLASS REFRACTOR: LED Tubes are aligned vertically and arranged radially to produce an even raw light distribution that simulates standard light sources. Array is secured within a 6" Prismatic Glass Refractor which provides the optical control. Used in conjunction with a clear patterned diffusing globe.

VERTICAL POWER ARRAY™: LED Tubes are aligned vertically and arranged radially to produce an even raw light distribution that simulates standard light sources. Produces a minimal glare, symmetric diffuse light distribution. Used in conjunction with an opal patterned diffusing globe.

LED EMITTERS

High Output LED's are driven at 350mA for nominal 1 Watt output each. LED's are available in standard Neutral White (4000K), or optional Cool White (5000K) or Warm White (3000K). Consult Factory for other LED options.

LED DRIVER

UL and CUL recognized High Power Factor, Constant Current LED drivers operate on input voltages from 120-277VAC, 50/60hz. Consult Factory for 347-480VAC. Driver is mechanically fastened to a retaining bracket. Main power quick disconnect provided. Driver has a minimum 4KV of internal surge protection, 10KV & 20KV Surge Protector optional. Dimming and High-Low Driver options available.

FINISH

Polyester powder coat incorporates four step iron phosphate process to pretreat metal surface for maximum adhesion. Top coat is baked at 400°F for maximum hardness and exterior durability.

PROJECT NAME: _____

PROJECT TYPE: _____



LAF

* SHOWN WITH STANDARD -YA FITTER

PATENT PENDING

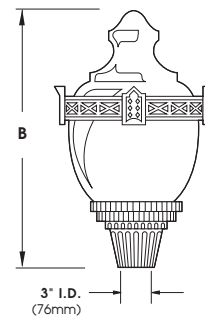
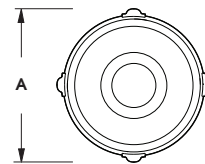

FIXTURE	A	B
LAF1*	19.5" 495mm	32" 813mm
LAF2*	17" 432mm	27.5" 699mm



2012140

LAF SERIES - LED

S P E C I F I C A T I O N S

OPTIONAL FITTERS



LAF1-YB



LAF2-YB



LAF1-YD*



LAF2-YD*

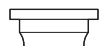

LAF1-YE*



LAF2-YE*



LAF1-YG



LAF2-YC

LED POWER ARRAY™ MODULES



LAF1-LED E.P.A. = 1.67

ANGLED ARRAY

Available in:
10 Array 80 LED Max.

GLASS REFRACTOR w/ VERTICAL ARRAY

Available in:
6 Array 36 LED Max.

VERTICAL ARRAY

Available in:
6 Array 48 LED Max.
8 Array 64 LED Max.
10 Array 80 LED Max.



LAF2-LED E.P.A. = 1.23

ANGLED ARRAY

Available in:
8 Array 48 LED Max.

GLASS REFRACTOR w/ VERTICAL ARRAY

Available in:
6 Array 36 LED Max.

VERTICAL ARRAY

Available in:
6 Array 48 LED Max.
8 Array 64 LED Max.

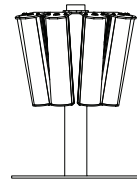

APA - Angled Array
Base mount

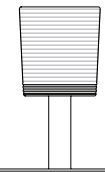

**GRV - Glass Refractor w/
Vertical Array**
Base mount

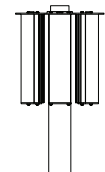

VPA - Vertical Array
Base mount

* AVAILABLE WITH MINI BUTTON PHOTOCELLS
SEE OPTIONS

(Specifications subject to
change without prior notice.)

BRASS
FINIAL

ORNAMENTAL
FINIAL

PATENT PENDING

O R D E R I N G I N F O R M A T I O N

LUMINAIRE-FITTER	OPTICS	# of LED's	COLOR	VOLTAGE	MOUNTING	FINISH	OPTIONS
LUMINAIRE	OPTICS	LED		MOUNTING		FINISH	OPTIONS
LUMINAIRE-FITTER	ANGLED POWER ARRAY (CLEAR PATTERNED LENS)	No. LEDs	COLOR	ARM MOUNT	STANDARD TEXTURED FINISH	LENS OPTIONS:	
<input type="checkbox"/> LAF1-LED-YA	<input type="checkbox"/> APA - II	LAF1	<input type="checkbox"/> NW (4000K)*	<input type="checkbox"/> 1	<input type="checkbox"/> BLACK	<input type="checkbox"/> CLEAR PATTERNED	<input type="checkbox"/> POLYCARBONATE ... CP (STANDARD GLOBE)
<input type="checkbox"/> LAF1-LED-YB	<input type="checkbox"/> APA - III	LAF2	<input type="checkbox"/> *STANDARD	<input type="checkbox"/> 2-180	<input type="checkbox"/> RAL-9005-T	<input type="checkbox"/> OPAL PATTERNED	
<input type="checkbox"/> LAF1-LED-YD	<input type="checkbox"/> APA - IV	<input type="checkbox"/> 80LED (89 Watts)	<input type="checkbox"/> CW (5000K)	<input type="checkbox"/> 2-90	<input type="checkbox"/> WHITE	<input type="checkbox"/> POLYCARBONATE ... WP	
<input type="checkbox"/> LAF1-LED-YE	<input type="checkbox"/> APA - V	<input type="checkbox"/> 48LED (53 Watts)	<input type="checkbox"/> WW (3000K)	<input type="checkbox"/> 3-90	<input type="checkbox"/> RAL-9003-T	<input type="checkbox"/> CLEAR PATTERNED	
<input type="checkbox"/> LAF1-LED-YG		<input type="checkbox"/> 60LED (67 Watts)	OTHER LED COLORS AVAILABLE CONSULT FACTORY	<input type="checkbox"/> 3-120	<input type="checkbox"/> GREY	<input type="checkbox"/> ACRYLIC ... CA	
		<input type="checkbox"/> 40LED (45 Watts)	VOLTAGE	<input type="checkbox"/> 4-90	<input type="checkbox"/> RAL-7004-T	<input type="checkbox"/> BRASS FINIAL ... BF	
		Wattages are Max Input Watts	<input type="checkbox"/> 120	<input type="checkbox"/> 3-90	<input type="checkbox"/> DARK BRONZE	<input type="checkbox"/> ORNAMENTAL FINIAL ... OF	
LUMINAIRE-FITTER	GLASS REFRACTOR (CLEAR PATTERNED LENS)	LAF1	<input type="checkbox"/> 208	<input type="checkbox"/> 3-120	<input type="checkbox"/> RAL-8019-T	<input type="checkbox"/> HOUSE SIDE SHIELD ... HS	
<input type="checkbox"/> LAF2-LED-YA	<input type="checkbox"/> GRV - III	LAF2	<input type="checkbox"/> 240	<input type="checkbox"/> 4-90	<input type="checkbox"/> GREEN	<input type="checkbox"/> DIMMABLE DRIVER(S) (0-10V) ... DIM	
<input type="checkbox"/> LAF2-LED-YB	<input type="checkbox"/> GRV - V	<input type="checkbox"/> 36LED (41 Watts)	<input type="checkbox"/> 277	WALL MOUNT	<input type="checkbox"/> RAL-6005-T	<input type="checkbox"/> HIGH-LOW DIMMING FOR HARDWIRED SWITCHING OR NON-INTEGRATED MOTION SENSOR ... HLSW	
<input type="checkbox"/> LAF2-LED-YD		<input type="checkbox"/> 32LED (36 Watts)	<input type="checkbox"/> 347	<input type="checkbox"/> WM		<input type="checkbox"/> PHOTO CELL + VOLTAGE (EXAMPLE: PC120V) ... PC+V	
<input type="checkbox"/> LAF2-LED-YE		<input type="checkbox"/> 40LED (45 Watts)	<input type="checkbox"/> 480	POST TOP		<input type="checkbox"/> 10KV SURGE PROTECTOR ... 10SP	
<input type="checkbox"/> LAF2-LED-YC	VERTICAL POWER ARRAY (OPAL LENS)	LAF1		<input type="checkbox"/> PT		<input type="checkbox"/> 20KV SURGE PROTECTOR (277V & 480V Only) ... 20SP	
	<input type="checkbox"/> VPA - SYM	LAF2					
		<input type="checkbox"/> 80LED (89 Watts)					
		<input type="checkbox"/> 64LED (72 Watts)					
		<input type="checkbox"/> 64LED (72 Watts)					
		<input type="checkbox"/> 48LED (53 Watts)					
		<input type="checkbox"/> 48LED (53 Watts)					
		<input type="checkbox"/> 36LED (41 Watts)					
		Wattages are Max Input Watts					