

SOLID STATE AREA LIGHTING

CTS SERIES-LED

SPECIFICATIONS

LUMINAIRE

Prismatic borosilicate glass refracting lens with specular top reflector. Heavy gauge, corrosion resistant cast aluminum housing. Utility Fitter base has panel for access to electrical compartment. Optional internal twist lock photocell available. Luminaire base has 3" I.D. opening for tenon. All hardware is stainless steel.

LED POWER ARRAY™

Three-dimensional array of individual LED Tubes fastened to a retaining plate. Each LED Tube consists of circuit board populated with a multiple of LED's and is mechanically fastened to a radial aluminum heat sink. An acrylic lens and end cap protects the LED Tube's internal components.

VERTICAL POWER™ ARRAY WITH REFRACTING

GLOBE: LED Tubes are aligned vertically and arranged radially to produce an even raw light distribution that simulates standard light sources. Used in conjunction with the external prismatic refracting lens which provides the optical control.

LED EMITTERS

High Output LED's are driven at 350mA for nominal 1 Watt output each. LED's are available in standard Neutral White (4000K), or optional Cool White (5000K) or Warm White (3000K). Consult factory for other LED options.

LED DRIVER

UL and CUL recognized High Power Factor, Constant Current LED drivers operate on input voltages from 120-277VAC, 50/60hz. Consult Factory for (347-480VAC). Driver is mechanically fastened to a retaining bracket. Main Power quick disconnect provided. Driver has a minimum 4KV of internal surge protection, 10KV & 20KV Surge Protector optional. Dimming and High-Low Driver options available.

FINISH

Polyester powder coat incorporates four step iron phosphate process to pretreat metal surface for maximum adhesion. Top coat is baked at 400°F for maximum hardness and exterior durability.

PROJECT NAME: _____

PROJECT TYPE: _____

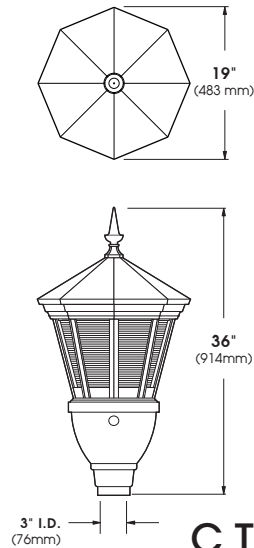

CTSN*

*SHOWN WITH -UB FITTER

PATENT PENDING

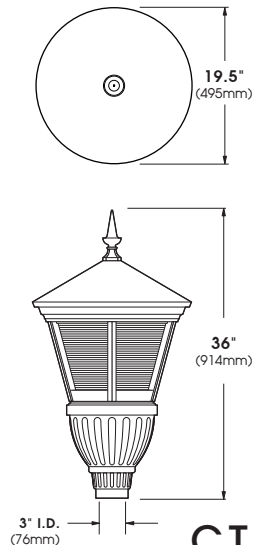

CTSR*

*SHOWN WITH -UA FITTER

PATENT PENDING



2013135

CTS SERIES - LED

S P E C I F I C A T I O N S

OPTIONAL FITTERS



UA

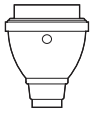

UB

ACCESSORIES

HOUSE SIDE SHIELD 90°, 180°

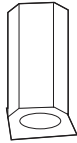

HS90°
HS180°

WALL MOUNT

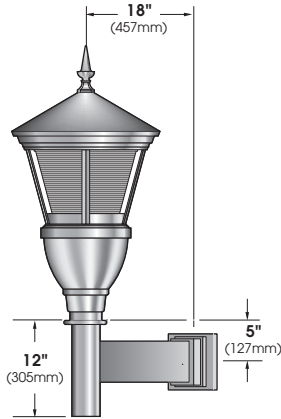

EXTRUDED ALUMINUM ARM BRACKET AND CAST ALUMINUM WALL BRACKET ASSEMBLY PROVIDED WITH BUILT IN GASKETED WIRE ACCESS FOR FIXTURE/SUPPLY WIRE CONNECTION.

WALL PLATE

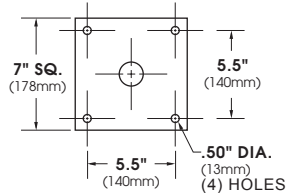

LED POWER ARRAY™ MODULES



CTSN-LED E.P.A.= 1.68

Available in:
8 Array 64 LED Max.
10 Array 80 LED Max

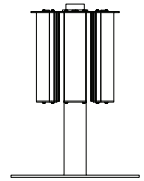

VPA - Vertical Array

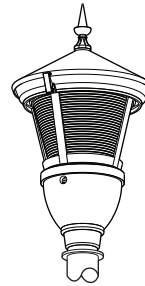

CTSR-LED E.P.A.= 1.68

Available in:
8 Array 64 LED Max.
10 Array 80 LED Max.

PATENT PENDING

O R D E R I N G I N F O R M A T I O N

LUMINAIRE	OPTICS	# of LED's	COLOR	VOLTAGE	MOUNTING	FINISH	OPTIONS
LUMINAIRE	OPTICS	LED			MOUNTING	FINISH	OPTIONS
LUMINAIRE	VERTICAL POWER ARRAY (CLEAR PRISMATIC GLOBE)	# of LEDs	COLOR	VOLTAGE	ARM MOUNT	STANDARD TEXTURED FINISH	
<input type="checkbox"/> CTSN-UA-LED <input type="checkbox"/> CTSN-UB-LED <hr/> <input type="checkbox"/> CTSR-UA-LED <input type="checkbox"/> CTSR-UB-LED	<input type="checkbox"/> VPA - III <input type="checkbox"/> VPA - V	<input type="checkbox"/> 80LED (90 Watts) <input type="checkbox"/> 64LED (71 Watts) <input type="checkbox"/> 48LED (53 Watts) <input type="checkbox"/> 36LED (41 Watts) Wattages are Max Input Watts	<input type="checkbox"/> NW (4000K)* *STANDARD <input type="checkbox"/> CW (5000K) <input type="checkbox"/> WW (3000K) OTHER LED COLORS AVAILABLE CONSULT FACTORY	<input type="checkbox"/> 120 <input type="checkbox"/> 208 <input type="checkbox"/> 240 <input type="checkbox"/> 277 <input type="checkbox"/> 347 <input type="checkbox"/> 480	<input type="checkbox"/> 1 <input type="checkbox"/> 2-180 <input type="checkbox"/> 2-90 <input type="checkbox"/> 3-90 <input type="checkbox"/> 3-120 <input type="checkbox"/> 4-90 WALL MOUNT <input type="checkbox"/> WM POST TOP <input type="checkbox"/> PT	<input type="checkbox"/> BLACK RAL-9005-T <input type="checkbox"/> WHITE RAL-9003-T <input type="checkbox"/> GREY RAL-7004-T <input type="checkbox"/> DARK BRONZE RAL-8019-T <input type="checkbox"/> GREEN RAL-6005-T FOR SMOOTH FINISH REMOVE SUFFIX "T" (EXAMPLE: RAL-9500) SEE USALTG.COM FOR ADDITIONAL COLORS	<input type="checkbox"/> HOUSE SIDE SHIELD...HS <input type="checkbox"/> DIMMABLE DRIVER(S) (0-10V)..... DIM <input type="checkbox"/> HIGH-LOW DIMMING FOR HARDWIRED SWITCHING OR NON-INTEGRATED MOTION SENSOR HLSW <input type="checkbox"/> TWIST LOCK PHOTO CELL + VOLTAGE (EXAMPLE: PC120V) TP+V <input type="checkbox"/> PHOTO CELL + VOLTAGE (EXAMPLE: PC120V) PC+V <input type="checkbox"/> 10KV SURGE PROTECTOR..... 10SP <input type="checkbox"/> 20KV SURGE PROTECTOR (277V & 480V Only) 20SP